

Shift Cable Adjustment

SRS wire harness is routed near the shift lever.

CAUTION:

- All SRS wiring harnesses are covered with yellow outer insulation.
- Before disconnecting any part of the SRS wire harness, install the short connectors (see [section 23](#)).
- Replace the entire affected SRS harness assembly if it has an open circuit or damaged wiring.

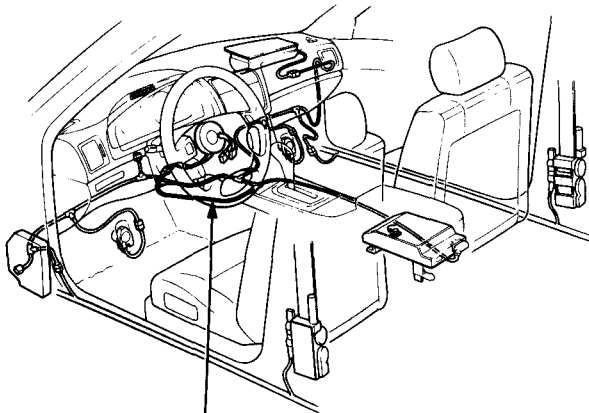

SRS MAIN HARNESS

1. Start the engine. Shift to reverse to see if the reverse gear engages. If not, refer to troubleshooting.
2. With the engine off, remove the console (see [section 20](#)).
3. Shift to **R** position, then remove the lock pin from the cable adjuster.

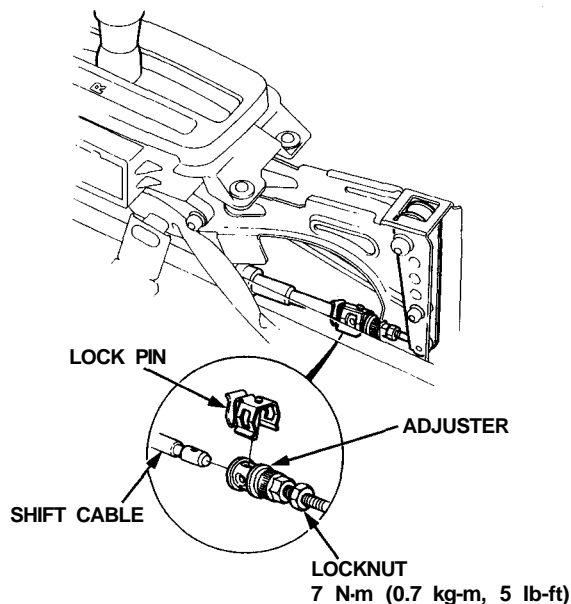

4. Check that the hole in the adjuster is perfectly aligned with the hole in the shift cable.

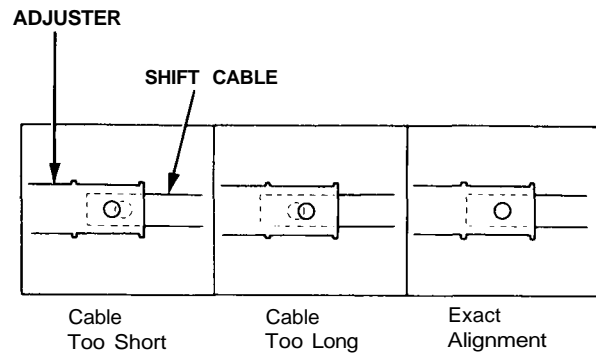

NOTE: There are two holes in the end of the shift cable. They are positioned 90° apart to allow cable adjustments in 1/4 turn increments.

5. If not perfectly aligned, loosen the locknut on shift cable and adjust as required.
6. Tighten the locknut.
7. Install the lock pin on the adjuster. If you feel the lock pin binding as you reinstall it, the cable is still out of adjustment and must be readjusted.
8. Move the selector lever to each gear and verify that the A/T gear position indicator follows the A/T gear position switch.
9. Start the engine and check the selector lever in all gears. If any gear does not work properly, refer to troubleshooting on page [14-78](#) thru [81](#).
10. Insert the ignition key into the key cylinder on the A/T gear position indicator panel, and verify that the shift lock lever is released.